



## 20407/22-36 Railway Terrace Milton QLD

1 1 1

From entry, you will appreciate the expansive living area, which in turn seamlessly opens onto the large private balcony, hosting attractive views of surrounding areas. Enjoy the stunning rooftop view of the Brisbane river/City skyline, or laze by the infinity pool and plush gardens featured on the 6th floor. All this, so conveniently located across the road from the local transit centre.

### Features:

Spacious open plan living area  
Large private undercover balcony providing beautiful views  
Generous sized study nook  
Half island stone kitchen benchtop with double basins, Bosch electric stove and dishwasher, ample bench/cupboard space

[For full version visit the website](https://www.eresidential.com.au)

<b>Type</b>	: Unit
<b>Price</b>	: New to Market
<b>Building Size</b>	: 57 sqm
<b>Land Size</b>	: 75 sqm
<b>View</b>	: <a href="https://www.eresidential.com.au/8180567">https://www.eresidential.com.au/8180567</a>



**Welly Cendana**  
07 3521 5478



**Peter Palmer**  
07 3521 5478

Welly Cendana | 0414 768 599  
welly@eresidential.com.au

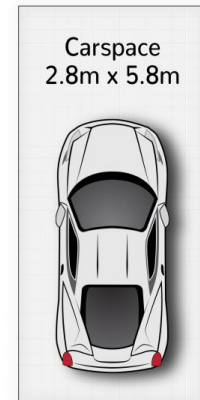
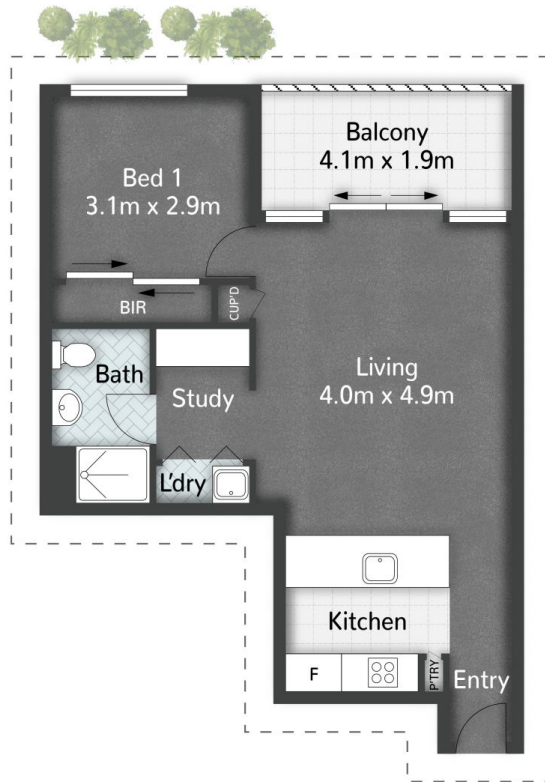

(Not In Position)



2407/22-36 Railway Terrace **MILTON**

1 | 1 | 1 | 57m<sup>2</sup> | 75m<sup>2</sup>

All dimensions are approximate; they are subject to errors and inaccuracies and no liability will be accepted.  
Plans are shown for marketing purposes only.

**eresidential**  
honesty. integrity. family.