



19 Overland Drive Edens Landing QLD

3 1 1

Positioned in a lovely leafy street, this beautifully updated home has so much to offer with quality finishes, a spacious living area, multipurpose room, and a covered balcony with serene treetop views across the escarpment all located in an established neighbourhood.

As you approach the front door, mature gardens enhance privacy and create a great first impression of the home. Head inside where the main living area welcomes you in like a warm summer breeze with an open plan design, timber flooring, neutral colours and plenty of natural light.

The updated kitchen makes preparing meals easy with modern appliances, pendant lighting, ample cabinets, and a walk-in pantry. Entertaining is a cinch as the living area flows out to the large balcony where you can enjoy a barbeque lunch with family and friends while you take in

Land Size : 742 sqm
View : <https://www.eresidential.com.au/8081939>



Ivan Chua
0451 890 772



Sandra Devi
07 3521 5478

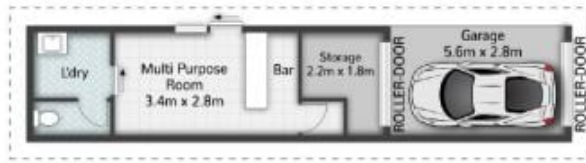

LOWER FLOOR



GROUND FLOOR



19 Overland Drive **EDENS LANDING**

3 Beds | 1 Bath | 1 Garage | 156m² | 742m²

All dimensions are approximate, they are subject to errors and inaccuracies and no liability will be accepted. Plans are shown for marketing purposes only.

eresidential
tenacity. integrity. family.