



**19 Overland Drive Edens Landing QLD**

3 1 2

**Desirable Family Home with Dual Living Potential**

Positioned in a lovely leafy street, this beautifully updated home has so much to offer with quality finishes, a spacious living area, multipurpose room, and a covered balcony with serene treetop views across the escarpment all located in an established neighbourhood.

As you approach the front door, mature gardens enhance privacy and create a great first impression of the home. Head inside where the main living area welcomes you in like a warm summer breeze with an open plan design, timber flooring, neutral colours and plenty of natural light.

The updated kitchen makes preparing meals easy with

[For full version visit the website](https://www.eresidential.com.au/8049945)

**Type** : House  
**Price** : \$ 690,000  
**Land Size** : 742 sqm  
**View** : <https://www.eresidential.com.au/8049945>



**Robby Christanto**  
07 3521 5478



**Ken Ardhiha**  
07 3521 5478



**Robby Christanto** | 0425 970 333  
 robby@eresidential.com.au



**Ken Ardhiha** | 0420 700 533  
 ken.ardhiha@eresidential.com.au

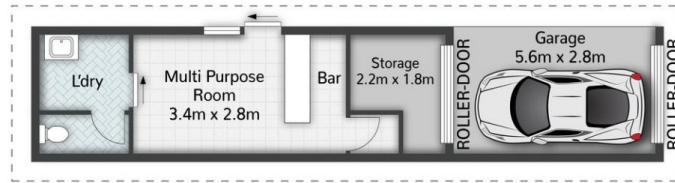

19 Overland Drive **EDENS LANDING**

3 | 1 | 1 | 156m<sup>2</sup> | 742m<sup>2</sup>

All dimensions are approximate; they are subject to errors and inaccuracies and no liability will be accepted.  
 Plans are shown for marketing purposes only.

