

## 33 Coldstream Way Holmview QLD

4 🛏️ 2 🚿 2 🚗

Charming home located at 33 Coldstream Way, Holmview, QLD 4207, featuring a welcoming façade with a stylish green picket fence and well-maintained garden. This property showcases a neat and modern exterior, complete with a single carport and additional off-street parking. The front yard is landscaped with a variety of plants and bushes, creating an inviting and private atmosphere. The property is accented by a combination of horizontal and vertical slat panels, enhancing both its aesthetic appeal and privacy.

**Land Size** : 466 sqm  
**View** : <https://www.eresidential.com.au/8040913>

### Key Features:

? Spacious and bright living area that leads to other parts of the home, maintaining the cohesive and contemporary design theme.

? Four generous sized bedrooms. All equipped with a ceiling fan to ensure comfort and built-in wardrobes for



**Ivan Chua**  
07 3521 5478



**Sandra Devi**  
07 3521 5478

# 33 Coldstream Way, Holmview

4 Bed 2 Bath 4 Car



FLOOR PLAN

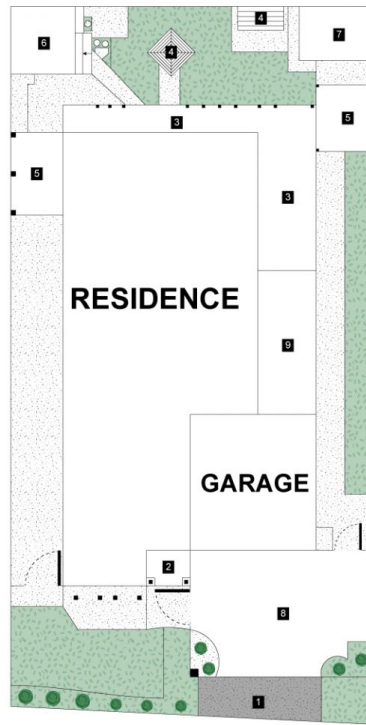

SITE PLAN

## LEGEND

1. Driveway
2. Porch
3. Outdoor Entertaining Area
4. Clothes Line
5. Patio
6. Studio
7. Shed
8. Carport
9. Storage

Internal : 157m<sup>2</sup>  
External : 60m<sup>2</sup>



All information contained herein is gathered by Little Hinges. Whilst the scanning technology is highly reliable, we cannot guarantee its accuracy and interested parties should rely on their own enquiries.

# 33 Coldstream Way, Holmview

4 Bed 2 Bath 4 Car



FLOOR PLAN

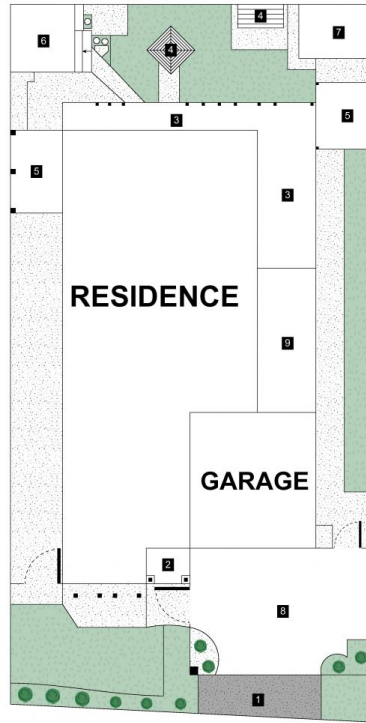

SITE PLAN

## LEGEND

1. Driveway
2. Porch
3. Outdoor Entertaining Area
4. Clothes Line
5. Patio
6. Studio
7. Shed
8. Carport
9. Storage

Internal : 157m<sup>2</sup>  
External : 60m<sup>2</sup>



All information contained herein is gathered by Little Hinges. Whilst the scanning technology is highly reliable, we cannot guarantee its accuracy and interested parties should rely on their own enquiries.