



### 19 Boyne Close Holmview QLD

4 2 2

Backing onto serene bushland, this stylish home offers the ultimate family lifestyle with a spacious open plan living area plus second loungeroom, a fantastic master suite, modern kitchen, and plenty of space to entertain.

Warm neutral tones and a spacious layout create a welcoming ambience as you step into the main living area while there is also another loungeroom at the front of the home, ideal for larger families. The beautiful kitchen is the heart of the home and showcases a sleek design, plenty of bench space for preparing meals, ample cabinets, and a large peninsula with room for seating.

Sliding doors open up the back of the home to the covered alfresco area and large backyard; perfect when entertaining family and friends. You can have a barbeque lunch on the patio with tranquil bushland views while the kids and pets

**Price** : \$ 780,000  
**Building Size** : 185 sqm  
**Land Size** : 499 sqm  
**View** : <https://www.eresidential.com.au/8035938>



**Robby Christanto**  
07 3521 5478



**Ken Ardhiha**  
07 3521 5478



**Robby Christanto** | 0425 970 333  
 robby@eresidential.com.au



**Ken Ardhiha** | 0420 700 533  
 ken.ardhiha@eresidential.com.au

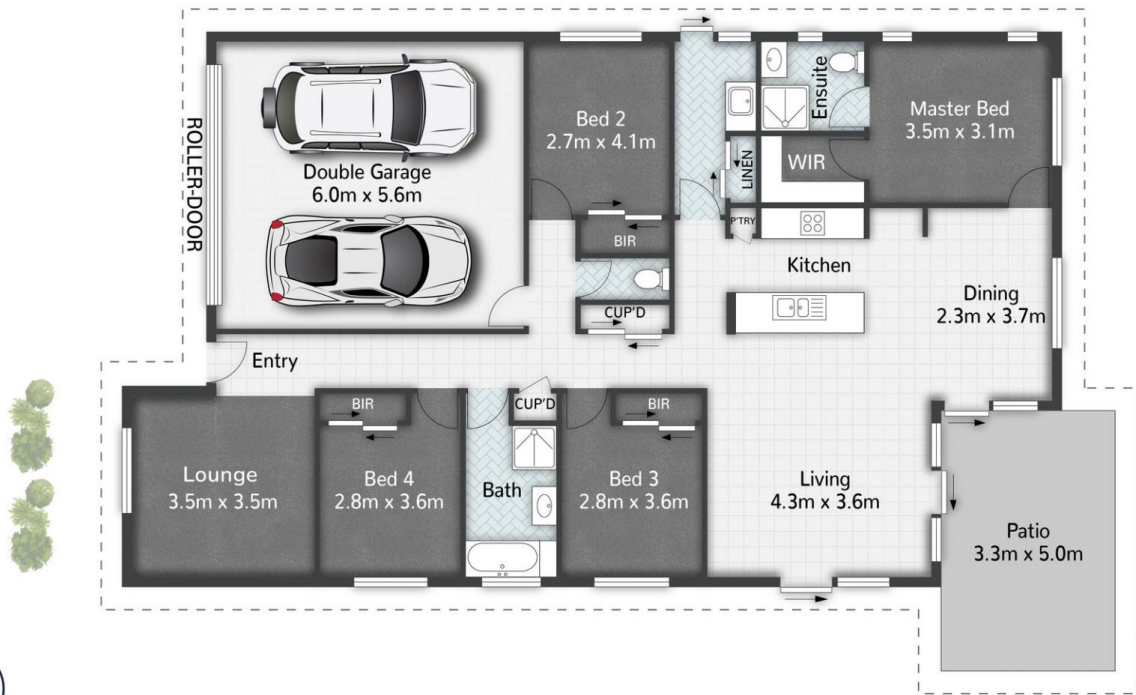

19 Boyne Close **HOLMVIEW**

4 | 2 | 2 | 185m<sup>2</sup> | 499m<sup>2</sup>

All dimensions are approximate; they are subject to errors and inaccuracies and no liability will be accepted.  
 Plans are shown for marketing purposes only.

**eresidential**  
 honesty, integrity, family.