

**18 Sandra-Ann Drive Edens Landing QLD**

4 🛏 2 🚿 2 🚗

Ideally positioned in an established neighbourhood, this spacious home has everything a family could want with two living areas, a large outdoor entertaining space, and a huge kitchen all set on a 600m2 elevated parcel of land.

As you enter the first dining and lounge room, you will be impressed by the size which can easily cater for extended family gatherings. Large windows allow the room to be filled with natural light while the wood heater will keep you warm and toasty in winter.

The kitchen is well equipped with plenty of cabinets, a hanging pot rack, dishwasher, modern design, and a large peninsula with room for seating. Flowing on from this main living area is the second spacious lounge room complete with air conditioning and a large bay window overlooking the front garden.

**Price** : \$ 700,000  
**Building Size** : 260 sqm  
**Land Size** : 600 sqm  
**View** : <https://www.eresidential.com.au/7816777>



**Robby Christanto**  
07 3521 5478



**Welly Cendana**  
07 3521 5478



**Robby Christanto** | 0425 970 333  
 robby@erestidential.com.au



**Welly Cendana** | 0414 768 599  
 welly@erestidential.com.au

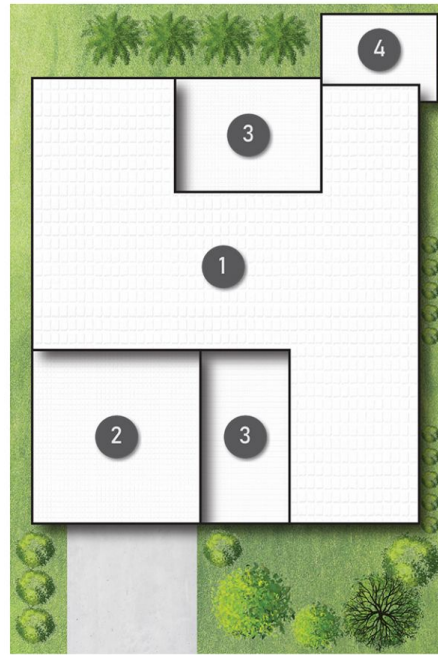

**LEGEND**

- 1 RESIDENCE
- 2 CARPORT
- 3 YARD
- 4 SHED

18 Sandra Ann Drive **EDENS LANDING**

4 | 2 | 2 | 260m<sup>2</sup> | 600m<sup>2</sup>

All dimensions are approximate; they are subject to errors and inaccuracies and no liability will be accepted. Plans are shown for marketing purposes only.

**erestidential**  
 honesty, integrity, family.