

20908/28 Merivale Street South Brisbane QLD

1 1 1

This modern, open plan designed apartment in the up market resort-style Eve complex situate on Merivale Street, offers first class facilities coupled with a relaxing view whilst seated on your private balcony/separate study nook area or bedroom.

Building Size : 51 sqm
Land Size : 56 sqm
View : <https://www.eresidential.com.au/7806205>

Features include:

Stylish unit providing modern open plan living areas
City views from balcony and bedroom
Study nook also included within extended balcony area
Half Island, stone bench kitchen with quality fittings, including microwave and dishwasher
Separated dining and lounge areas with extended ceiling height
The well-sized bedroom enjoys city views, built in mirrored wardrobes, and affords direct access onto the balcony as



Ivan Chua
0451 890 772

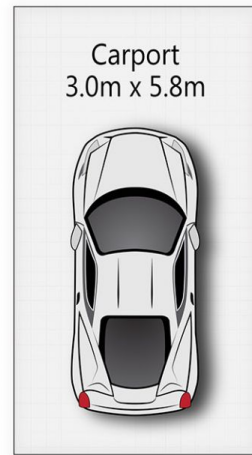
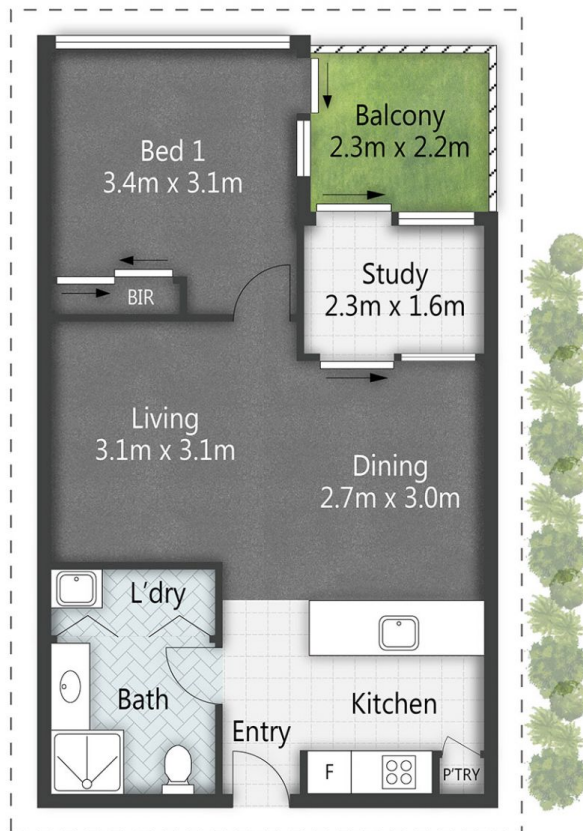

(Not In Position)

20908/28 Merivale Street **SOUTH BRISBANE**

1 | 1 | 1 | 67m²

All dimensions are approximate; they are subject to errors and inaccuracies and no liability will be accepted.
Plans are shown for marketing purposes only.

eresidential
honesty, integrity, family.