



**6 Lange Court Calamvale QLD**

4 2 2

Everything has been thought of in this spacious home which has something for every member of the family including the pets, with multiple living areas, a well-appointed kitchen that overlooks the pristine backyard and large alfresco, a water tank and 5 kw solar panels, all set on a 675m2 block.

From the moment you enter, you'll appreciate the well-designed floorplan, which positions the two living areas to have views of the gardens. A timber floor media room overlooks the front yard while a tiled combined living, dining and kitchen directs your gaze to the luscious green lawn out the back.

Air conditioning to the main living areas make them

[For full version visit the website](https://www.eresidential.com.au/7806015)

**Type** : House  
**Price** : \$ 855,000  
**Building Size** : 226 sqm  
**Land Size** : 675 sqm  
**View** : <https://www.eresidential.com.au/7806015>



**Welly Cendana**  
07 3521 5478



**Sandra Devi**  
07 3521 5478

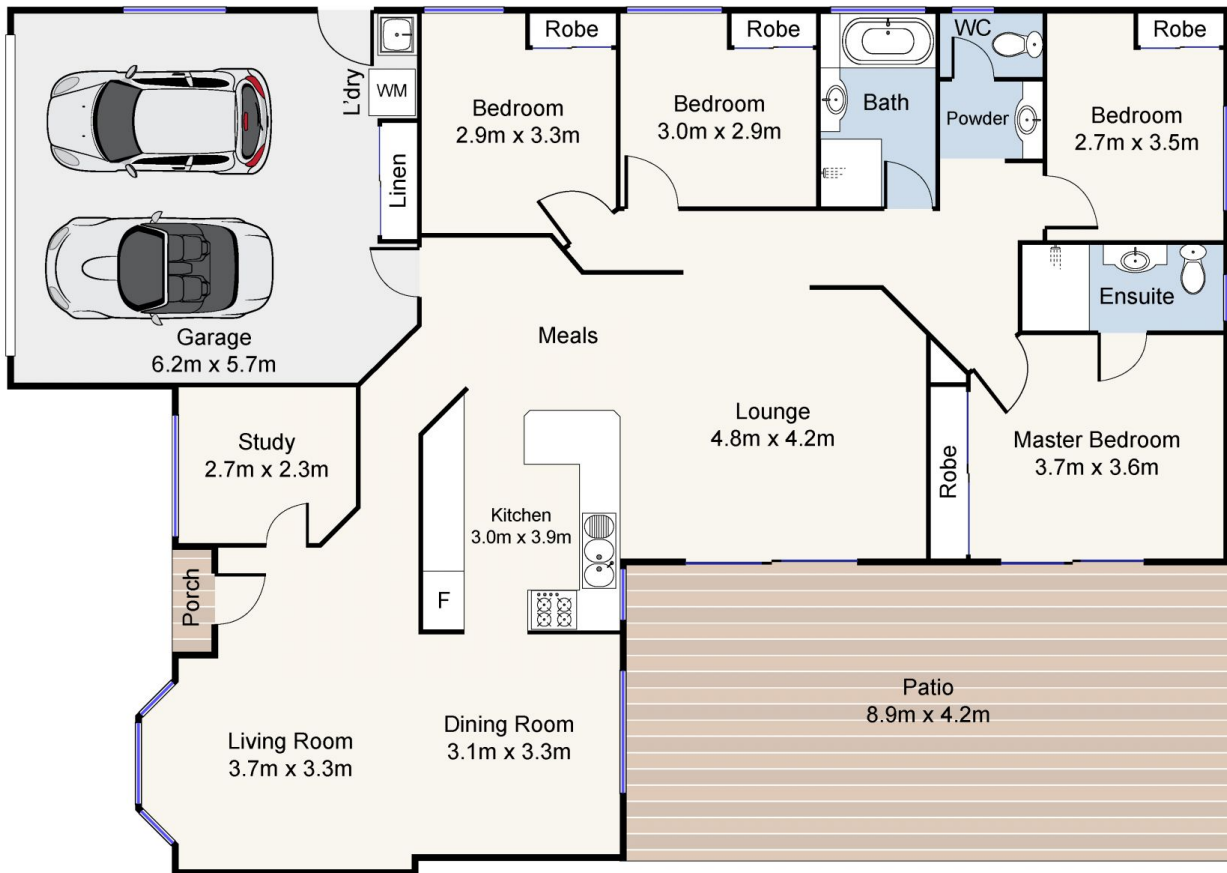

0 1 2 3 4 5

Scale in meters. Indicative only. Dimensions are approximate. All information contained herein is gathered from sources we believe to be reliable. However, we cannot guarantee its accuracy and interested persons should rely on their own enquiries.

INT: 186 m<sup>2</sup>  
EXT: 40 m<sup>2</sup>

Produced by [Open2view.com](http://Open2view.com)

**eresidential**

6 Lange Court, Calamvale